

# CT Wetland In Lieu Fee (ILF) 2023 Grant Program Update

Anthony Zemba

Senior Environmental Analyst  
Certified Ecologist  
and Soil Scientist



LANDTECH



# The ILF Program:



## An alternative to permittee-responsible wetland mitigation

Audubon CT is the sponsor of CT's ILF Program for aquatic resource compensatory mitigation required by the Army Corps authorizations.

- **Sale of credits** generates funds
- **Release of credits** makes funds available for grants used to create, enhance, protect additional wetland acreage

# ILF Grant Process Overview

- A **Cooperating Entity (CE)** identifies a project in a “service area”
- CE submits **Letter of Intent (LOI)**
- If eligible, CE asked to submit a **Full Application & draft Mitigation Plan**
- Applications reviewed by **Project Advisory Committee (PAC)**
- PAC scores projects; best projects are recommended to an **Interagency Review Team (IRT)**





# If approved, the CE then...



- Enters into a **Project Agreement** with Audubon
- Provides **legal documents** to Audubon
- Secures a **land protection instrument**
- Finalizes **mitigation and management plans**
- Designs & implements project **as soon as possible or within one year**, then...
- Monitors the site pursuant to Corps **mitigation guidelines**

# Projects Eligible for ILF Funding

- Wetland **Creation**
- Wetland **Restoration**
- Wetland **Enhancement**
- Wetland **Preservation**  
(but only if it includes one  
or more of the above)





A close-up photograph of several green, blade-like leaves of a plant, likely an iris, with several small, white, daisy-like flowers in bloom. The background is a soft-focus green.

# Summary of ILF Program 2016–2022

- **\$2.75 million** awarded to date
- **240 acres** of wetlands created, restored, enhanced or preserved
- **1,085 acres** of total land protected
- Over **28,000 linear feet of riverine habitat** enhanced
- **26 state-listed species** (including 3 federal) confirmed on ILF sites
- Habitat for **98 Greatest Conservation Need** species protected
- **7 Critical Habitats** are purported to occur on among the various ILF-acquired lands

# What Makes for a Successful Project?

- Meets goals & objectives of the Service Area
- Creates, restores, enhances and protects the most wetland acreage
- “Shovel Ready”
- Contains rare habitats, rare species or both
- Connects adjacent existing preserves

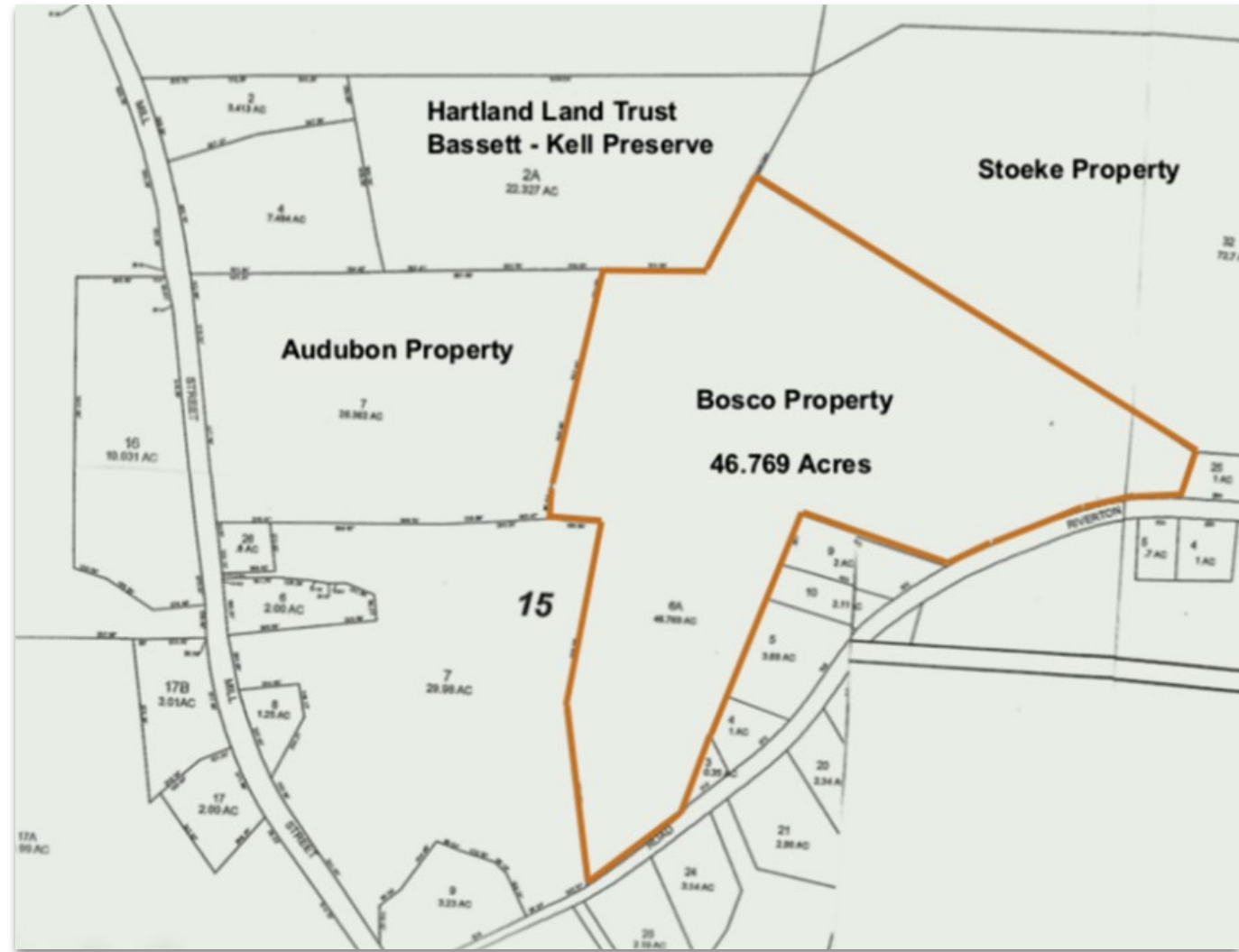

Bosco Property Acquisition – Hartland, CT





*Thermal pool treatment on the Salmon Kill, Salisbury, CT*

# Salmon Kill Creek Restoration

- **Restored degraded stream reaches** that were adversely impacted by agricultural land use
- Addressed **ongoing bank erosion**
- **Restored streamside vegetation** to shade stream corridor and stabilize banks
- **Added in-stream habitat attributes** to sustain coldwater fishery
- **Reach now protected** by livestock fencing and a conservation easement



- Second to **last barrier** to be crossed in a series of seven barriers along the Falls River
- Allows passage of diadromous fish to **upstream spawning habitat**
- The last barrier preventing river herring from reaching **10-acre upstream breeding habitat** removed



*Dolan Pond Fishway, Essex*

# Stratford Point Marsh Restoration

- **Restored Saltmarsh** lost due to excavation as a remedial measure to remove lead shot from the intertidal zone
- **One component** of a multi-faceted habitat restoration plan
- Removed failing and damaged tide gates to **restore tidal flushing**
- Restored Saltmarsh serves to attenuate wave energy and prevent further erosion of the adjacent upland habitats





# Great Meadows Marsh Restoration

- **Removed dredged spoil material** from the marsh
- Removed **miscellaneous debris**
- Removed failing and damaged tide gates to **restore tidal flushing**
- Replanted and re-graded areas to **allow formation of high marsh** habitat and control of Phragmites





# What's Required of a Cooperating Entity?

- Property Owner Permission
- Requisite Permits (if required)
- Environmental Due Diligence
- Property Boundary Survey
- Land Protection Instrument in perpetuity
- Recent Appraisal
- Mitigation Plan & Requisite Monitoring
- Long Term Management Plan





# Funds Available for 2023\*

| Service Area        | \$ Available     |
|---------------------|------------------|
| Connecticut River   | <b>962</b>       |
| Housatonic River    | <b>130,389</b>   |
| South-Central Coast | <b>228,334</b>   |
| Southeast Coast     | <b>325,138</b>   |
| Southwest Coast     | <b>3,885</b>     |
| Thames River        | <b>3,737,558</b> |

*\*As of January 31st, 2023*



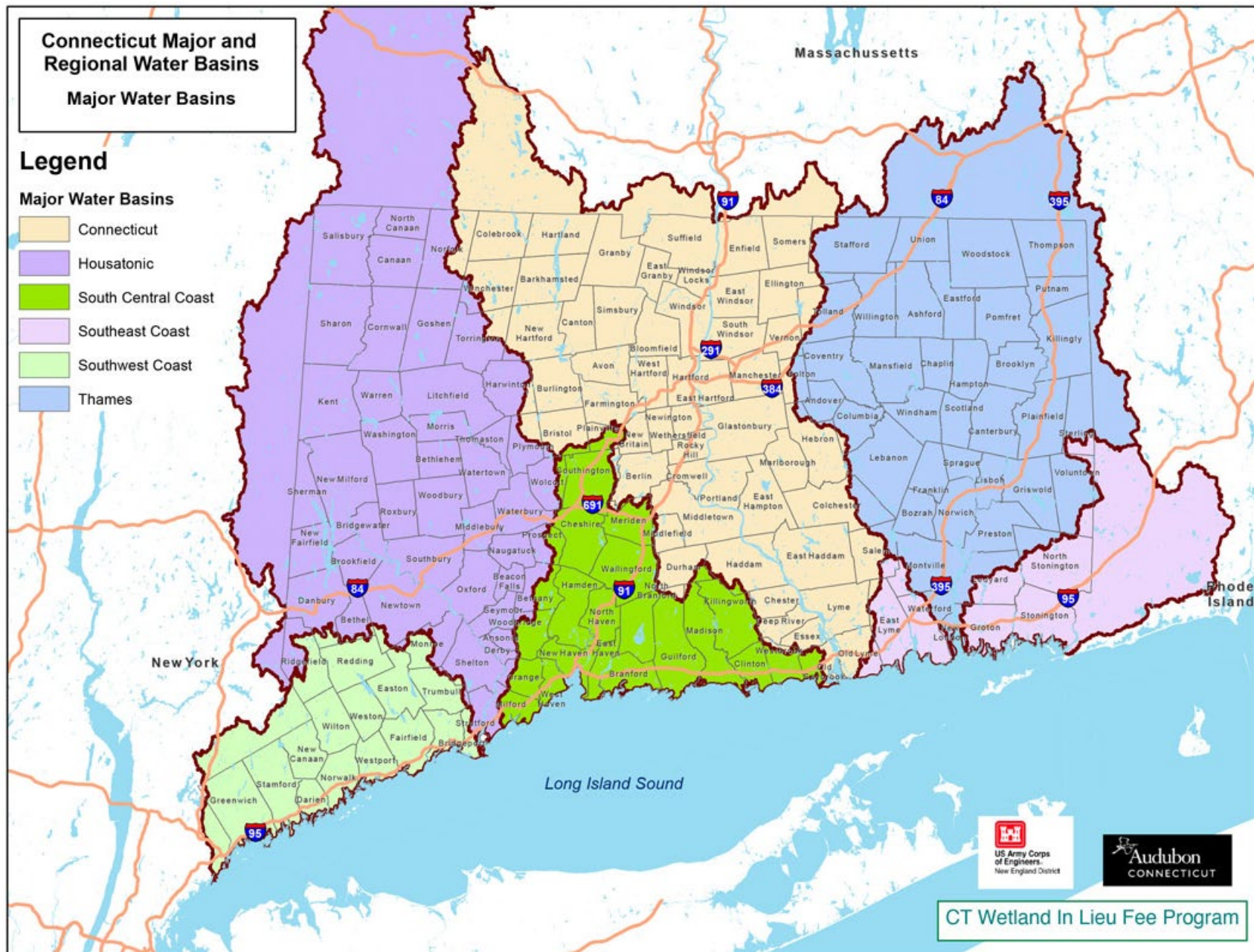

# ILF Service Areas

LANDTECH





# 2023 Schedule

| Milestone  | Tentative Time Period         |
|--|-------------------------------|
| Letters of Intent (LOI) Deadline   | <b>May - June</b>             |
| LOIs screened, applicants of appropriate projects send letters to request full proposals | <b>End of June/Early July</b> |
| Deadline for invited parties to submit full proposals                                    | <b>Early July</b>             |
| PAC reviews plans, conducts site visits, and ranks projects                              | <b>Late July</b>              |
| IRT selects finalists  | <b>August</b>                 |
| Finalize project Agreements  | <b>December</b>               |



# Restoration & Enhancement Projects in Connecticut

- Indian River Culvert Removal – Orange
- Saltmarsh Restoration – Stratford
- Salmon Kill Creek Restoration – Salisbury
- Dolan Pond Fishway – Centerbrook
- Harrison Property Stewardship – North Branford
- Mad River Headwaters Restoration – Norfolk
- Norwalk River Restoration and Enhancement – Wilton
- Roger Tory Peterson Center Riparian Forest Restoration – Old Lyme
- Jepp Brook – Brand Property Acquisition & Enhancement – Hamden



# Preservation Projects in Connecticut

- Lukaszec Property Acquisition – Thompson
- Zemko Property Acquisition – Salem
- Stoeke Property Acquisition – Hartland
- Grobe Property Acquisition – Bethany
- Simpson Property Acquisition – Bethany
- Danforth Property Acquisition – Colebrook
- Fromson/Strassler Property Acquisition – Weston
- Bloomingfield Farm Conservation Easement – Sherman
- Ricci Property Acquisition – Cheshire
- Alba Pavan Preserve Acquisition – Manchester
- Ayer's Point Property Acquisition – Old Saybrook
- Jepp Brook – Brand Property Acquisition & Enhancement – Hamden





Find Out More...

**Visit:**

<http://ct.audubon.org/conservation/in-lieu-fee-program>

**Contact:**

**Anthony Zemba**

Senior Environmental Analyst  
Certified Ecologist and  
Soil Scientist

203-454-2110 x 190

[azemba@landtechconsult.com](mailto:azemba@landtechconsult.com)

LANDTECH