

CT Wetland In Lieu Fee (ILF) 2025 Grant Program Update

Anthony Zemba

Senior Environmental Analyst
Senior Ecologist / Soil Scientist



LANDTECH



The ILF Program:

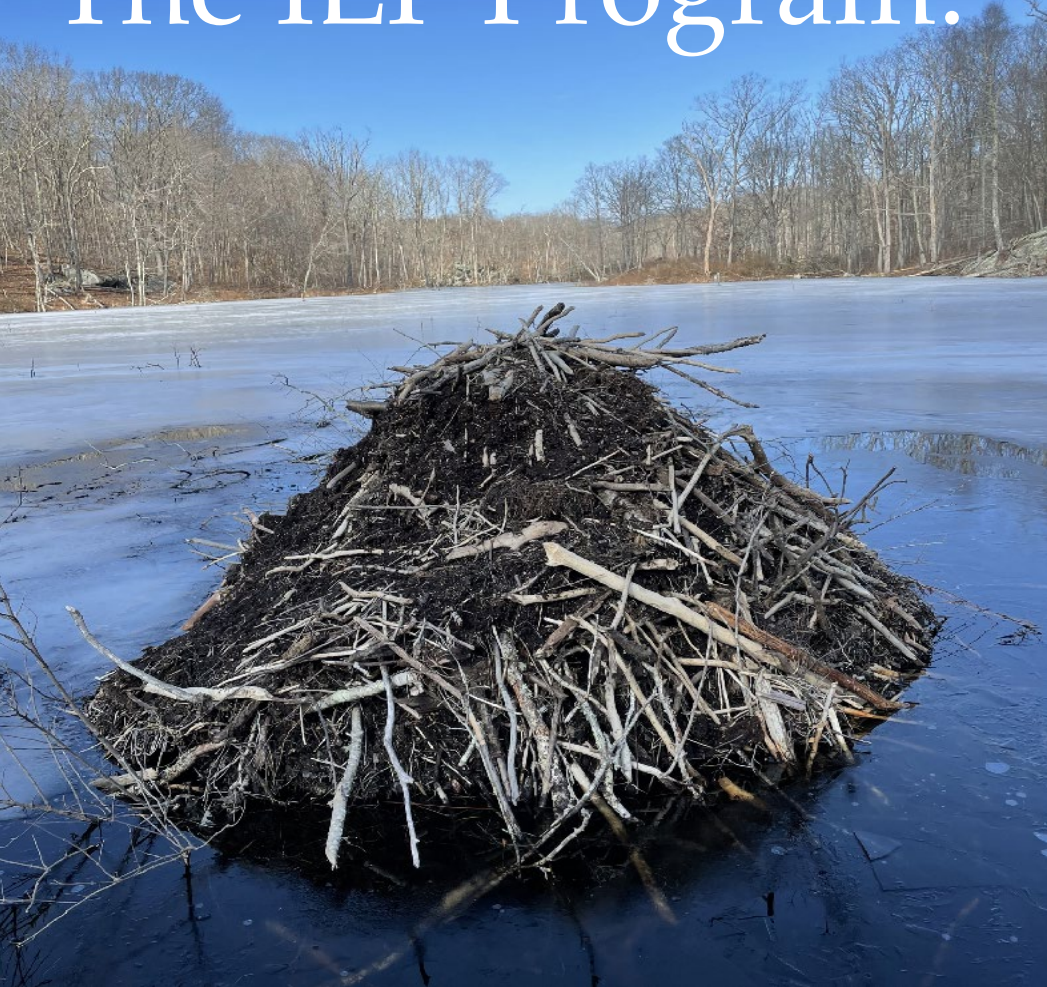

An alternative to permittee-responsible wetland mitigation

Audubon CT is the sponsor of CT's ILF Program for aquatic resource compensatory mitigation required by the Army Corps authorizations.

- **Sale of credits** generates funds
- **Release of credits** makes funds available for grants used to create, enhance, protect additional wetland acreage

ILF Grant Process Overview

- A **Cooperating Entity (CE)** identifies a project in a “service area”
- CE submits **Letter of Intent (LOI)**
- If eligible, CE asked to submit a **Full Application & draft Mitigation Plan**
- Applications reviewed by **Project Advisory Committee (PAC)**
- PAC scores projects; best projects are recommended to an **Interagency Review Team (IRT)**
- IRT makes decision on who is funded



If approved, the CE then...



- Enters into a **Project Agreement** with Audubon
- Provides **legal documents** to Audubon
- Secures a **land protection instrument**
- Finalizes mitigation and management plans
- Designs & implements project within one year or **as soon as possible** then...
- Monitors the site pursuant to Corps **mitigation guidelines**

Projects Eligible for ILF Funding

- Wetland **Creation**
- Wetland **Restoration**
- Wetland **Enhancement**
- Wetland **Preservation**
(but only if it includes one
or more of the above)



Who is Eligible for Funding?

- Municipalities
- State Government Agencies
- Non-profit Organizations
- Academic Institutions



Sacred Heart
UNIVERSITY



Salem Land Trust



NORTH BRANFORD
LAND CONSERVATION
TRUST, INC.

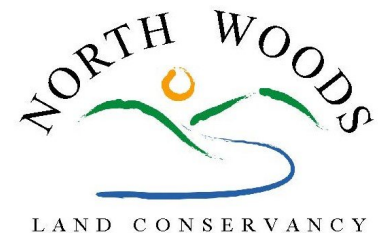

THE BETHANY LAND TRUST
Bethany's link to nature



Summary of ILF Program 2016–2024

- **\$3.58 million** awarded to date
- **240 acres** of wetlands created, restored, enhanced or preserved
- **1,085 acres** of total land protected
- Over **29,850 linear feet of riverine habitat** enhanced
- **26 state-listed species** (including 3 federal) confirmed on ILF sites
- Habitat for **98 CT Greatest Conservation Need** species protected
- **7 CT Critical Habitats** are purported to occur on the various ILF-acquired lands

What Makes for a Successful Project?

- Meets goals & objectives of the Service Area
- Creates, restores, enhances and protects the most wetland acreage
- “Shovel Ready”
- Contains rare habitats, rare species or both
- Connects adjacent existing preserves

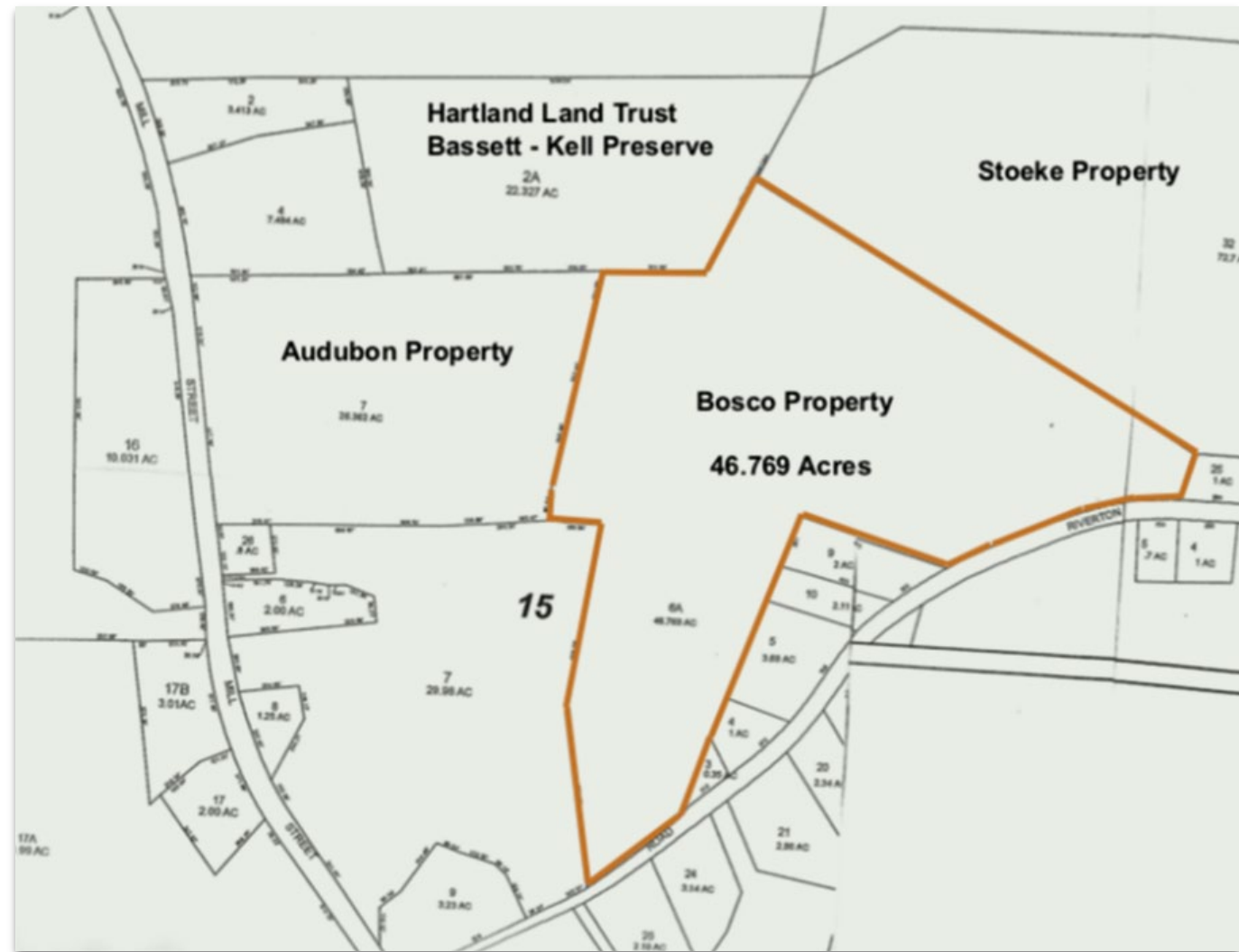

Bosco Property Acquisition – Hartland, CT



Thermal pool treatment on the Salmon Kill, Salisbury, CT

Salmon Kill Creek Restoration

- **Restored degraded stream reaches** that were adversely impacted by agricultural land use
- Addressed **ongoing bank erosion**
- **Restored streamside vegetation** to shade stream corridor and stabilize banks
- **Added in-stream habitat attributes** to sustain coldwater fishery
- **Reach now protected** by livestock fencing and a conservation easement

Dolan Pond Fishway

- Second to **last barrier** to be crossed in a series of seven barriers along the Falls River
- Allows passage of diadromous fish to their **spawning habitats**
- The last barrier preventing river herring from reaching **10-acre upstream breeding habitat** removed



Centerbrook Architects Fishway on the Falls River, Essex

Stratford Point Marsh Restoration

- **Restored Saltmarsh** lost due to excavation as a remedial measure to remove lead shot from the intertidal zone
- **One component** of a multi-faceted habitat restoration plan
- Restored Saltmarsh serves to attenuate wave energy and prevent further erosion of the adjacent upland habitats



Jarvis Creek Restoration

Branford, CT



- Restoration Project
- Allows for landward migration of salt marsh communities

Mamacoke Island Restoration



GreenVest LLC*
 35A Kennedy Road
 Tranquility, NJ 07879
 732.902.6644 (p)

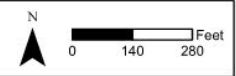

**Mamacoke Island Aquatic
 Habitat Restoration
 Project**

Overall Mitigation Plan
 Connecticut College
 Mamacoke Island
 Town of Waterford, CT

Legend

- Stream Restoration
- 35' Riparian Stream Buffer
- Goliath Reefballs
- Bio-sill
- Sill
- Intertidal Subtidal Shallows Rehabilitation/Enhancement
- Low Marsh
- Proposed Equalizer Culvert
- Existing Culvert
- Intertidal/Subtidal Shallows Re-Establishment
- Phragmites Removal/ Intertidal Marsh Rehabilitation
- High Marsh Enhancement/Preservation

Stage	Project Element	Mitigation Type	Resource Type	Acres/LF
1 (ILF)	1a	Re-Establishment	Low Marsh	0.75
	1b	Rehabilitation/Enhancement	Intertidal/Subtidal Shallows	1.87
	1c	Enhancement/Preservation	High Marsh	2.71
	1d	Rehabilitation/Enhancement	High Marsh	0.27
Stage 1 Acres Subtotal				5.61
2 (Others)	2a	Re-Establishment	Low Marsh	0.80
	2b	Enhancement/Preservation	High Marsh	0.85
	2c	Re-Establishment	Intertidal/Subtidal Shallows	1.69
	2d	Rehabilitation/Enhancement	High Marsh	0.19
	2e	Restoration	Stream	1500
Stage 2 Acres Subtotal				5.97

Document Path: X:\Planning_Design\INITIATIVES\CT_ILF_2023\ConnColl_Ph1_Phases1&2.mxd

What's Required of a Cooperating Entity?

- Property Owner Permission
- Requisite Permits
- Environmental Due Diligence
- Property Boundary Survey
- Land Protection Instrument
- Recent Appraisal
- Other administrative documents
- Mitigation Plan & Requisite Monitoring
- Long Term Management Plan



Preservation Projects in Connecticut

- Lukaszeczek Property Acquisition – Thompson
- Zemko Property Acquisition – Salem
- Stoeke Property Acquisition – Hartland
- Bosco A and Bosco B Property Acquisitions – Hartland
- Grobe Property Acquisition – Bethany
- Simpson Property Acquisition – Bethany
- Danforth Property Acquisition – Colebrook
- Belnap Preserve & Fromson/Strassler Property Acquisitions – Weston
- Bloomingfield Farm Protection via Conservation Easement – Sherman
- Fenn Road (Ricci Property) Acquisition – Cheshire
- Alba Pavan Preserve Acquisition – Manchester
- Ayer's Point Property Acquisition – Old Saybrook
- Jepp Brook – (Brand Property) Acquisition & Enhancement – Hamden

Restoration, Enhancement & Stewardship Projects in Connecticut

- Indian River Culvert Removal – Orange
- Stratford Point Saltmarsh Restoration – Stratford
- Salmon Kill Creek Restoration – Salisbury
- Dolan Pond Fishway – Centerbrook
- Harrison Property Stewardship & Habitat Enhancement – North Branford
- Norwalk River Restoration and Enhancement – Wilton
- Jepp Brook – Brand Property Acquisition & Enhancement – Hamden
- Tri-town Forest & Green Falls Glen Preserves Stewardship – North Stonington, Preston
- Jarvis Creek Restoration – Branford
- Thames River – Mamacoke Cove Restoration – Waterford

New Credit Costs Per Square Foot for Each Service Area

Palustrine Systems =
wetlands

Service Area	Notes	Credit Cost Per Square Foot ¹
Housatonic River		\$ 7.56
Southwest Coastal		\$ 11.97
South-central Coastal		\$ 9.89
Connecticut River		\$10.11
Thames River	South of I-95	\$10.80
	North of I-95	\$ 7.97
Southeast Coastal		\$ 9.46

Riverine Systems =
watercourses or “stream credits”

Service Area	Credit Cost*
Housatonic River	\$ 210.00
Southwest Coastal	\$ 311.00
South-central Coastal	\$ 311.00
Connecticut River	\$ 213.00
Thames River	\$ 209.00
Southeast Coastal	\$ 301.00

Tenative Funds Available for 2025*

Service Area	\$ Available
Connecticut River	\$966,425
Housatonic River	\$138,245
South-Central Coast	\$569,615
Southeast Coast	\$347,542
Southwest Coast	\$N/A
Thames River	\$N/A

*As of March 4th, 2025



ILF Service Areas

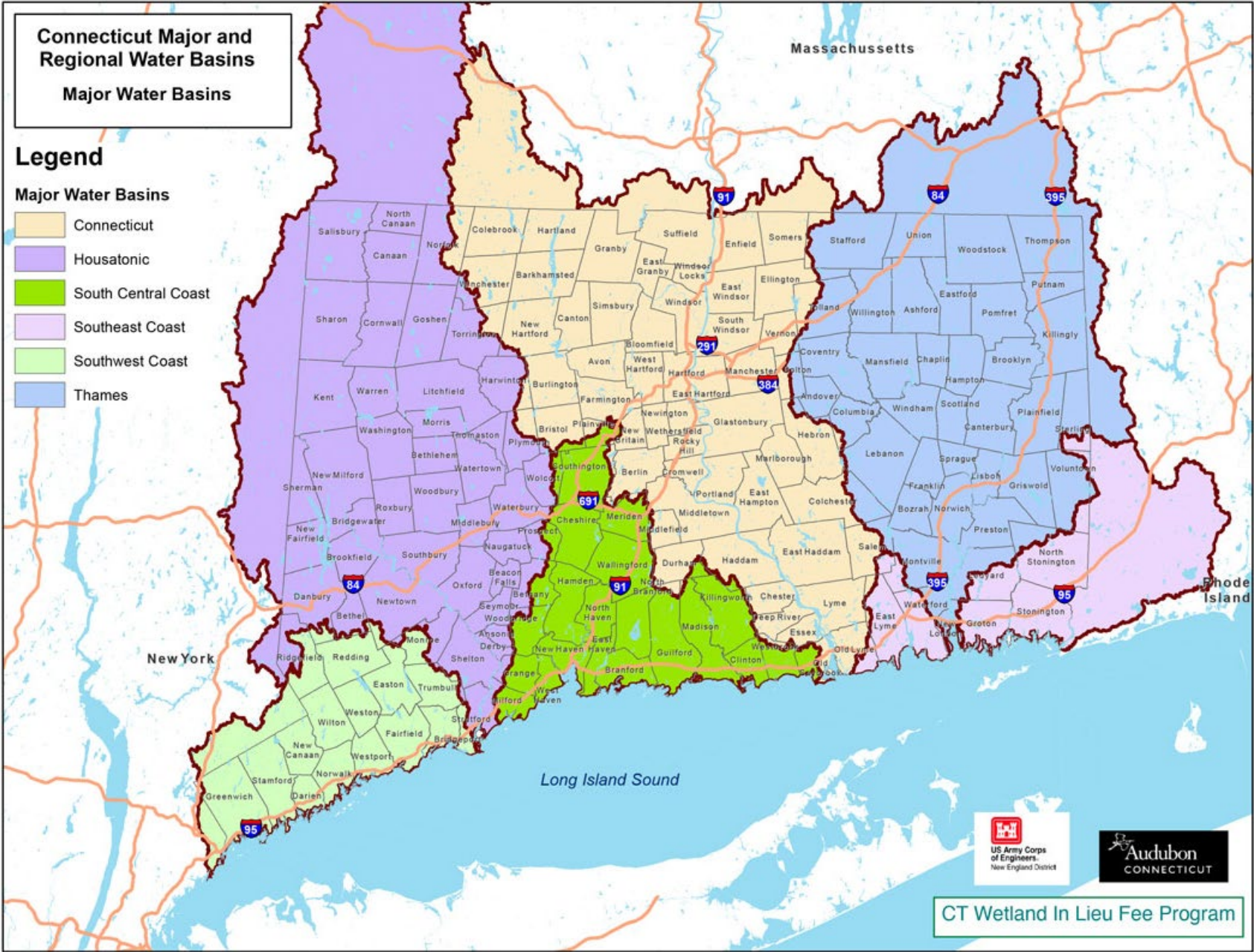



Tentative Schedule

Milestone	Tentative Time Period
Letters of Intent (LOI) Deadline	May - June
LOIs screened, applicants of appropriate projects send letters to request full proposals	End of June/Early July
Deadline for invited parties to submit full proposals	Early July
PAC reviews plans, conducts site visits, and ranks projects	Late July
IRT selects finalists	August
Finalize project Agreements	December



Find Out More...

Visit:

<http://ct.audubon.org/conservation/in-lieu-fee-program>

Contact:

Anthony Zemba

Senior Environmental Analyst

Senior Ecologist / Soil Scientist

203-454-2110 x 190

azemba@landtechconsult.com

LANDTECH